

MOUNTING

1. Snap the sensor unit firmly into the belt connector
2. Adjust the belt length as needed.
3. Moisten the belt electrode areas with water or electrode gel
4. Wear the belt against your bare skin for best results. Put the belt on so that it fits snugly. RUNTEQ logo facing up and forward

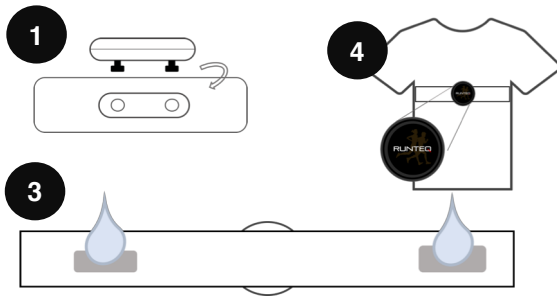

CONNECTING TO DEVICES

RUNTEQ Smart Running Sensor is compatible with Bluetooth® Low Energy devices, such as sports watches or mobile devices with sports apps.

Connecting procedures may vary so please refer to the instructions of your mobile application or sports watch for guidance.

When connecting the first time, it is recommended that you are at least 10 m (33 ft) away from other Bluetooth sensors. You can pair the belt with multiple sports watches and apps, but only one connection can be active at a time.

BATTERY

RUNTEQ Smart Running Sensor uses a 3-Volt lithium cell (CR 2025) battery. With RUNTEQ app, you can check the battery status from the device information when the sensor is connected. To replace the battery:

1. Remove the sensor from the belt.
2. Open the battery cover with the clip of belt
3. Replace the battery.
4. Firmly close the battery cover.

OPERATING ENVIRONMENT

- Operating temperature:
20° C to +60° C/-5° F to +140° F
- Storage temperature:
30° C to +60° C/-22° F to +140° F
- Water resistance: 30 m/100 ft

CARING

- Do not pull the RUNTEQ Smart Running Sensor module off the belt. This may damage the belt connectors. Unsnap one side at a time.
- The belt should be machine washed in 30° C after every 2-3 exercises.
- Never machine wash the RUNTEQ Smart Running Sensor module. Machine washing may damage the module. Rinse the sensor under water and dry.

DISCLAIMER

Runteq Ltd disclaims any and all liabilities related to third parties' products (excluding Suunto product included into the sales package) and services.



Quick Start Guide

GETTING STARTED

Thanks for choosing RUNTEQ Smart Running Sensor. We wish you enjoyable running exercises.

To use your RUNTEQ Smart Running Sensor:

- Download RUNTEQ App (if you want to use all features),
- Connect the sensor with your watch or smartphone,
- Snap in the sensor to the belt and wear the belt around your chest

SUPPORT



For instructions and safety information, see the RUNTEQ Smart Running Sensor User Guide. Download the PDF at www.runteq.com/support

For warranty and service information, see www.runteq.com/support

VISIT US ONLINE



runteq.com



runteq



runteq



runteq

WARNINGS

- CONTAINS SMALL PARTS. NOT SUITABLE FOR CHILDREN UNDER AGE 3.
- IN THE CASE OF ALLERGIC REACTIONS OR SKIN IRRITATIONS, STOP USE IMMEDIATELY
- ALWAYS CONSULT YOUR DOCTOR BEFORE BEGINNING AN EXERCISE PROGRAM. OVEREXERTION MAY CAUSE SERIOUS INJURY.
- PEOPLE WHO HAVE A PACEMAKER, DEFIBRILLATOR, OR OTHER IMPLANTED ELECTRONIC DEVICE USE THE TRANSMITTER BELT AT THEIR OWN RISK.
- THE DEVICE AND APP ARE ONLY FOR RECREATIONAL USE.

CAUTIONS

- DO NOT APPLY SOLVENT OF ANY KIND OR INSECT REPELLENT ONTO THE PRODUCT, AS IT MAY DAMAGE THE SURFACE.
- TREAT IT AS ELECTRONIC WASTE TO PRESERVE THE ENVIRONMENT.
- DO NOT KNOCK OR DROP THE DEVICE, AS IT MAY BE DAMAGED.

